

MATERIAL KEY

- 30 YEAR ASPHALT SHINGLES
- CEMENT BOARD SIDING (4\"/>
- CEMENT BOARD SIDING (4\"/>

SITE STATISTICS LOT A
 LOT SIZE 270 M SQ / 2,906 SQ.'
 UNIT SIZE 1,618 SQ.'
 DENSITY .56
 LOT COVERAGE 1,096 SQ.' OR 37.7%
 PARKING PROVIDED 2

SITE STATISTICS LOT B
 LOT SIZE 209 M SQ / 2,250 SQ.'
 UNIT SIZE 1,618 SQ.'
 DENSITY .72
 LOT COVERAGE 1,096 SQ.' OR 48.7%
 PARKING PROVIDED 2

AUG 2013

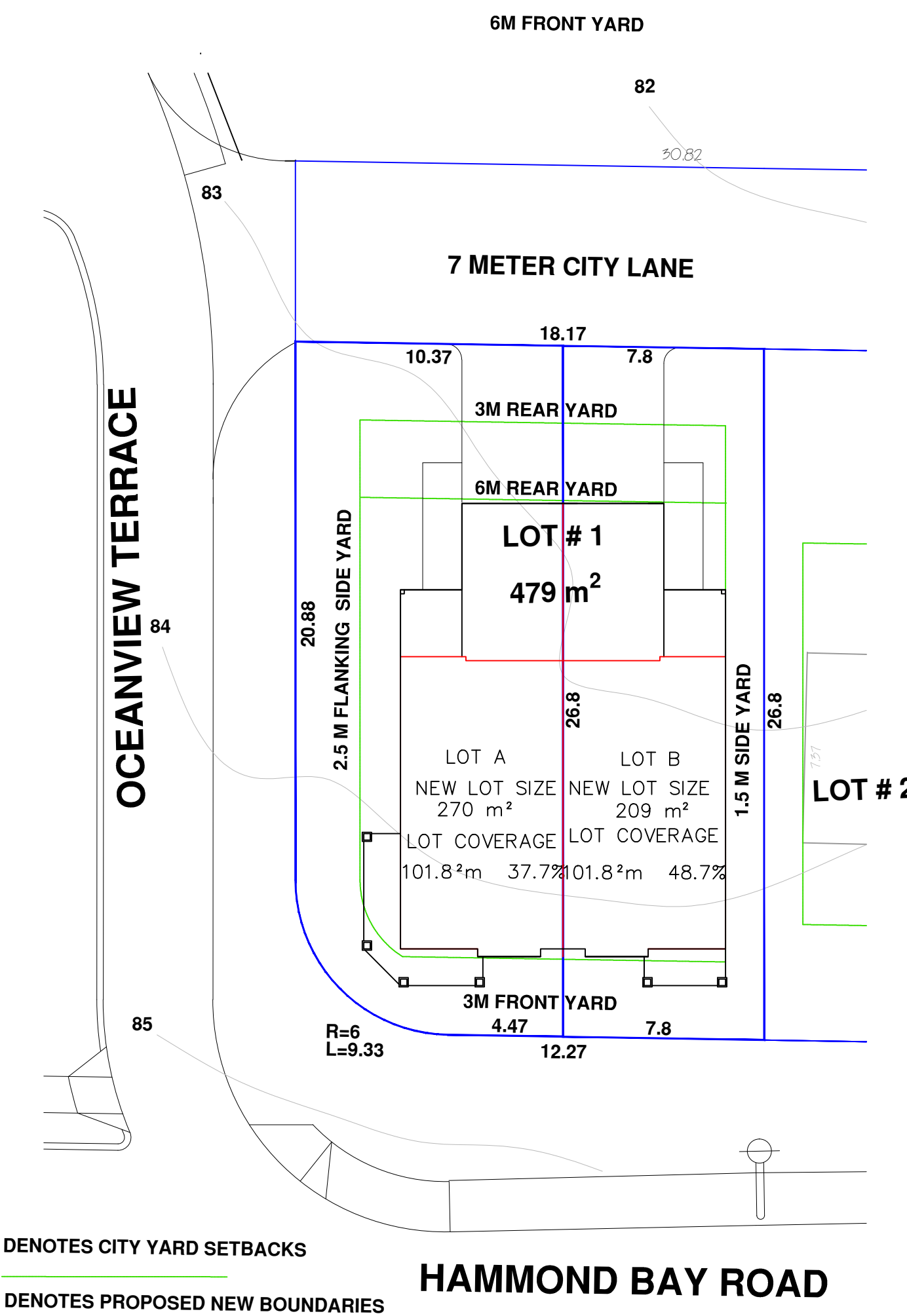

DENOTES CITY YARD SETBACKS
 DENOTES PROPOSED NEW BOUNDARIES

HAMMOND BAY ROAD

SITE PLAN
 1/16 = 1'

HAMMOND BAY REZONE

5620 HAMMOND BAY ROAD,
 NANAIMO, BC
 Folio: 08190.050
 Plan: 26105
 Size: 0.50 ACRES
 Legal Description: LOT A, DISTRICT LOT 40, WELLINGTON DISTRICT, PLAN 26105

NEW LOT # 1 OF SUBDIVISION
 Zone R1
 SINGLE DWELLING RESIDENTIAL

REZONE TO R7
 ROW HOUSE RESIDENTIAL
 SUBDIVIDE TO 2 LOTS

NOTES; DATE;

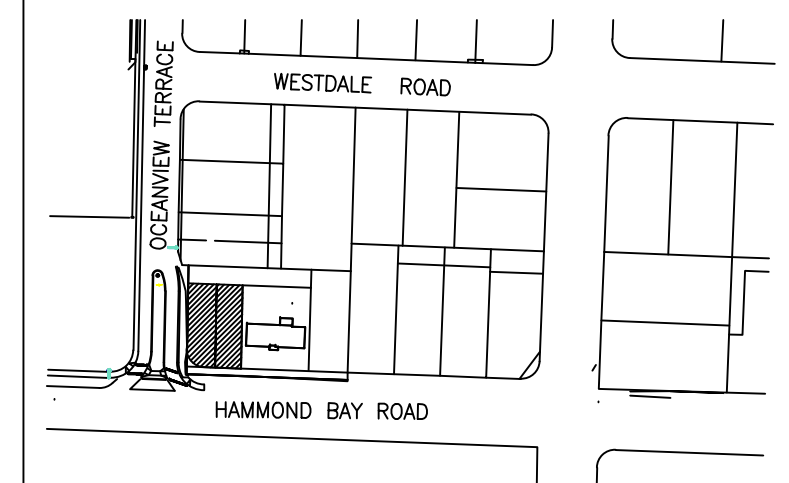

4 SITE DESIGN LTD.
 Mark Garrett
 7180 Lancrest Terr.
 BOX 24 Lantzville B.C. V0R 2H0
 Skype; nanaimomark
 (250) 802-1027 May-Oct
 email-garrettbydesign@yahoo.com

Copyright reserved. These plans and designs are at all times the property of the design company, and are for the sole use for the project shown. Written consent is required from the designer before any reproduction. Contractor to verify all lines, levels, surveys, dimensions, specifications, location of building site, and location of all services prior to construction. All work to be done in accordance with the B.C. building code, current edition, and all local building bylaws.

DRAWN BY: MARK GARRETT
 DATE: AUG 2013
 SCALE: AS SHOWN

PROJECT NO. DRAWING NO.

ELEVATIONS
PLANS
SITE PLAN